

**ITEM 11. MOBILE CRANES – TEMPORARY ROAD CLOSURES –  
COMMONWEALTH STREET SURRY HILLS**

**TRIM RECORD NO: 2016/446192**

**RECOMMENDATION**

It is recommended that the Committee endorse the temporary road closure of Commonwealth Street, between Hunt and Goulburn Streets, Surry Hills, on Sunday 6 November 2016 from 7am to 5pm, subject to the following conditions:

- (A) The Applicant must comply with the temporary road closure conditions as mentioned in Schedule C of this Agenda.
- (B) The Applicant must comply with any other conditions imposed by City's Construction Regulation Unit.
- (C) The Applicant has indicated the Sunday 13 November 2016 as an alternative date for the above work as a contingency for inclement weather.
- (D) The Applicant must contact the Surry Hills Police to obtain a separate police permit and to discuss deployment of user pay police for the road closure.
- (E) The Applicant is to obtain a Road Occupancy Licence from the Transport Management Centre prior to commencement of works.
- (F) If the above closure dates conflict with any works associated with the CBD and South East Light Rail (CSELR) project, Sydney City Centre Access Strategy (SCCAS) or any other major works or special events, they may be changed to new dates in consultation with the Transport Management Centre and the Surry Hills Police.
- (G) The Applicant must provide a telephone number of the supervisor responsible for the proposed closure and include contact details in the notification letters to be distributed to affected stakeholders.
- (H) The Applicant must contact Sydney Buses and arrange and pay for the rerouting of bus services around the closure, the temporary relocation of bus stops and any additional staff required.

**VOTING MEMBERS FOR THIS ITEM**

<b><i>Voting Members</i></b>	<b><i>Support</i></b>	<b><i>Object</i></b>
City of Sydney		
Roads and Maritime Services		
NSW Police – Surry Hills LAC		
Representative for the Member for Sydney		

**DECISION**

## **BACKGROUND**

Alert Traffic Control has applied for the temporary road closure of Commonwealth Street, between Hunt and Goulburn Streets, Surry Hills, on Sunday 6 November 2016 from 7am to 5pm.

## **COMMENTS**

The proposed temporary road closure is required to allow a mobile crane to install a tower crane on the frontage of 74-76 Commonwealth Street, Surry Hills.

The Applicant has provided a site-specific Traffic Control Plan that includes details of barricades, signs, flagmen and other traffic devices to implement the proposed road closure.

Given the 301, 302 and 303 services currently use Commonwealth Street between Goulburn and Campbell Streets, the Applicant has been in consultation with Sydney Buses about the temporary closure. It has been confirmed that during the closure services will be diverted via Goulburn and Riley Streets and the Applicant will pay for the rerouting of bus services around the closure, the temporary relocation of bus stops and any additional staff required.

There are currently no other approved temporary road closures proposed to take place on the same day in close proximity of this closure.

The temporary road closure will not affect any other properties, as local access will be provided at all times and alternative access routes are available nearby.

A Traffic Management Plan (TMP) for the temporary road closure was approved by Roads and Maritime Services (RMS).

## **CONSULTATION**

The Applicant will be required to notify affected stakeholders as stipulated in Schedule C.

## **FINANCIAL**

All costs associated with the proposed closure will be borne by the Applicant.

## **ATTACHMENTS**

Mobile Cranes – Temporary Road Closures – Commonwealth Street Surry Hills

Sairam Jegatheeswaran, Engineering Traffic Officer

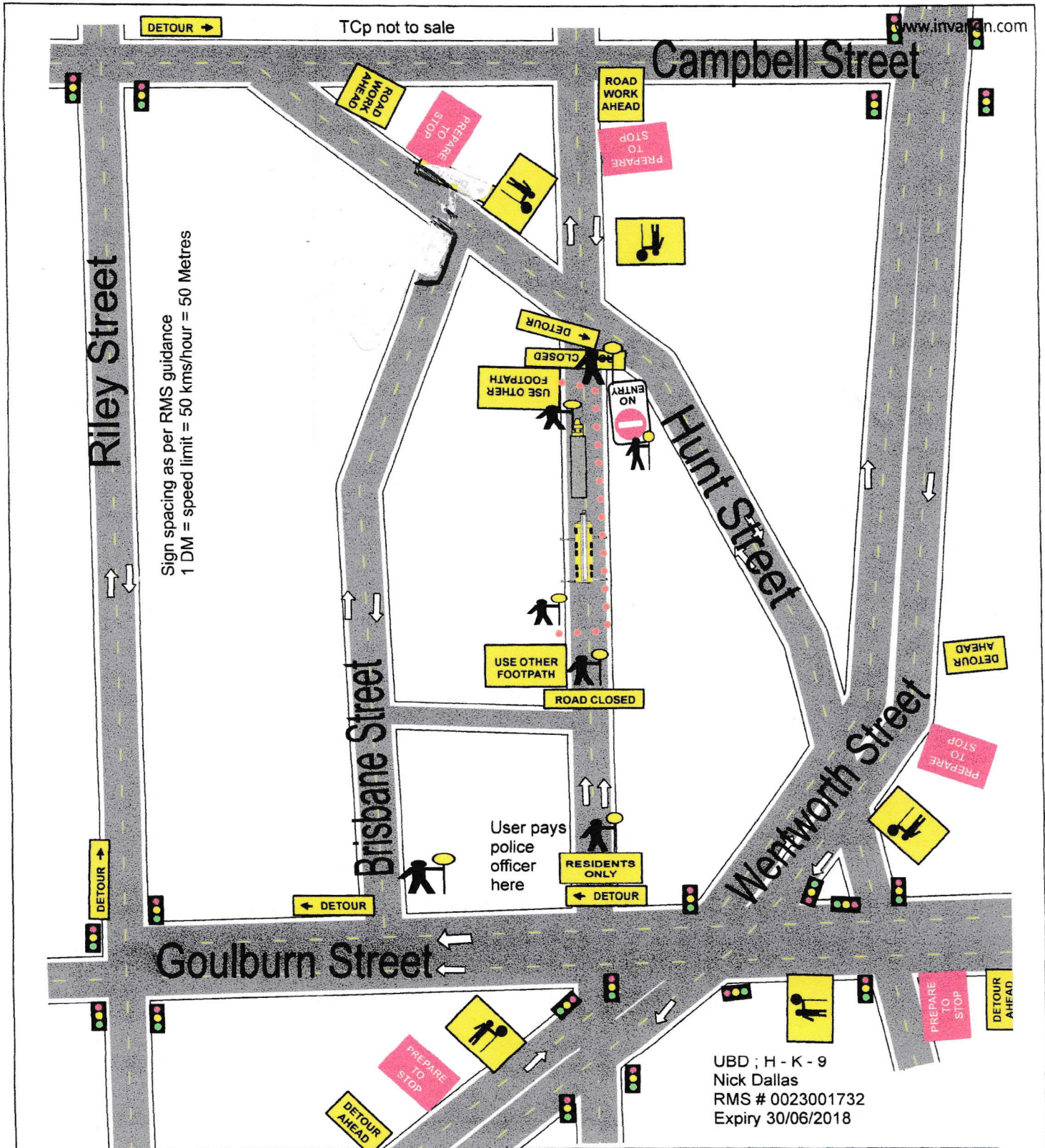

**Date:** 9/30/2016 **Author:** Nick Dallas **Project:** #74 - 76 Commonwealth St . Surry Hills

**Comments:**  
 Closure of Commonwealth St between Goulburn St & Hunt St .  
 Traffic may be stopped for 3 minutes .  
 Pedestrians to be guided to use other footpath past work area .  
 Signs spacing & TCP according to A.S 1742.3  
 Only RMS accredited traffic controllers to stop & guide traffic .  
 Emergency vehicles allowed into closed area under guidance form traffic control.  
 No driveway access impeded.  
 User pays police officer to be on site whilst Commonwealth St is closed .

